

**TYPE A1**

42.0 m<sup>2</sup> / 452 ft<sup>2</sup>  
(inclusive of 5m<sup>2</sup> Balcony & 3m<sup>2</sup> AC Ledge)

- Blk 19, #02-04\* to #04-04\*  
#02-05\* to #04-05\*  
#02-06 to #04-06
- Blk 21, #02-11 to #04-11  
#02-12 to #04-12

**TYPE A1-G**

56.0 m<sup>2</sup> / 603 ft<sup>2</sup>  
(inclusive of 5m<sup>2</sup> PES, 3m<sup>2</sup> AC Ledge & 14m<sup>2</sup> Void over Living, Dining & Kitchen)

- Blk 19, #01-04\*, #01-05\* & #01-06
- Blk 21, #01-11 to #01-12

**TYPE A1-PH**

56.0 m<sup>2</sup> / 603 ft<sup>2</sup>  
(inclusive of 5m<sup>2</sup> Balcony, 3m<sup>2</sup> AC Ledge & 14m<sup>2</sup> Void over Living, Dining & Kitchen)

- Blk 19, #05-04\*, #05-05\* & #05-06
- Blk 21, #05-11 to #05-12

*\*Mirror Image*

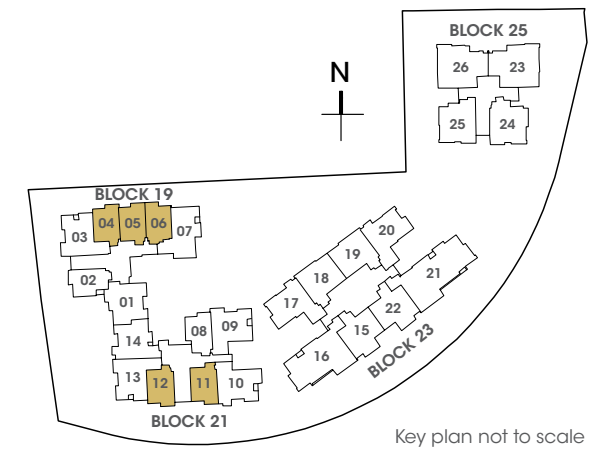

A HOUSE IS MADE WITH WALLS AND BEAMS;  
A HOME IS BUILT WITH  
**LOVE AND DREAMS.**

*Ralph Waldo Emerson*

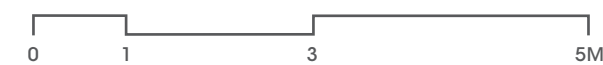
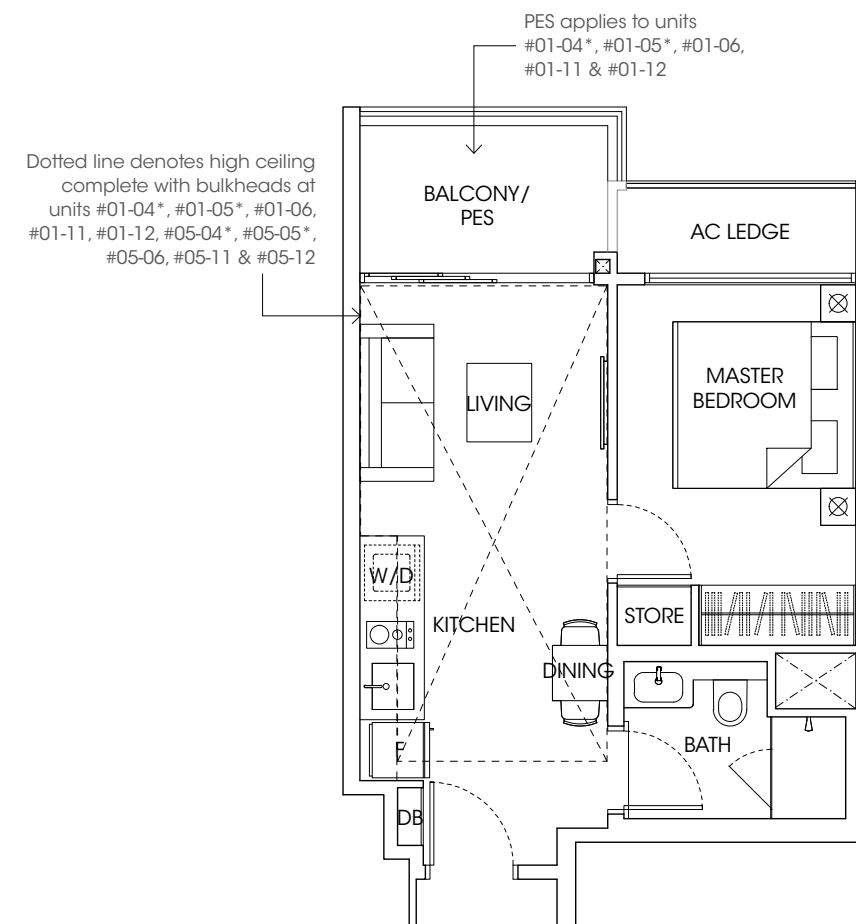

**LEGEND:**

- Washer/Dryer
- Fridge
- Distribution Board

All plans are subject to changes by the relevant authorities. Measurements are approximate only and subject to final survey. Information accurate at the point of printing.  
BP no.: A712-04181-2018-BP01

**TYPE A1A**

42.0 m<sup>2</sup> / 452 ft<sup>2</sup>  
(inclusive of 5m<sup>2</sup> Balcony & 3m<sup>2</sup> AC Ledge)

Blk 21, #02-08 to #04-08

**TYPE A1A-G**

56.0 m<sup>2</sup> / 603 ft<sup>2</sup>  
(inclusive of 5m<sup>2</sup> PES, 3m<sup>2</sup> AC Ledge & 14m<sup>2</sup> Void over Living, Dining & Kitchen)

Blk 21, #01-08

**TYPE A1A-PH**

56.0 m<sup>2</sup> / 603 ft<sup>2</sup>  
(inclusive of 5m<sup>2</sup> Balcony, 3m<sup>2</sup> AC Ledge & 14m<sup>2</sup> Void over Living, Dining & Kitchen)

Blk 21, #05-08

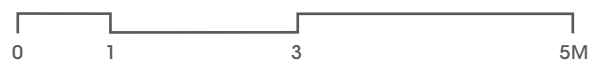
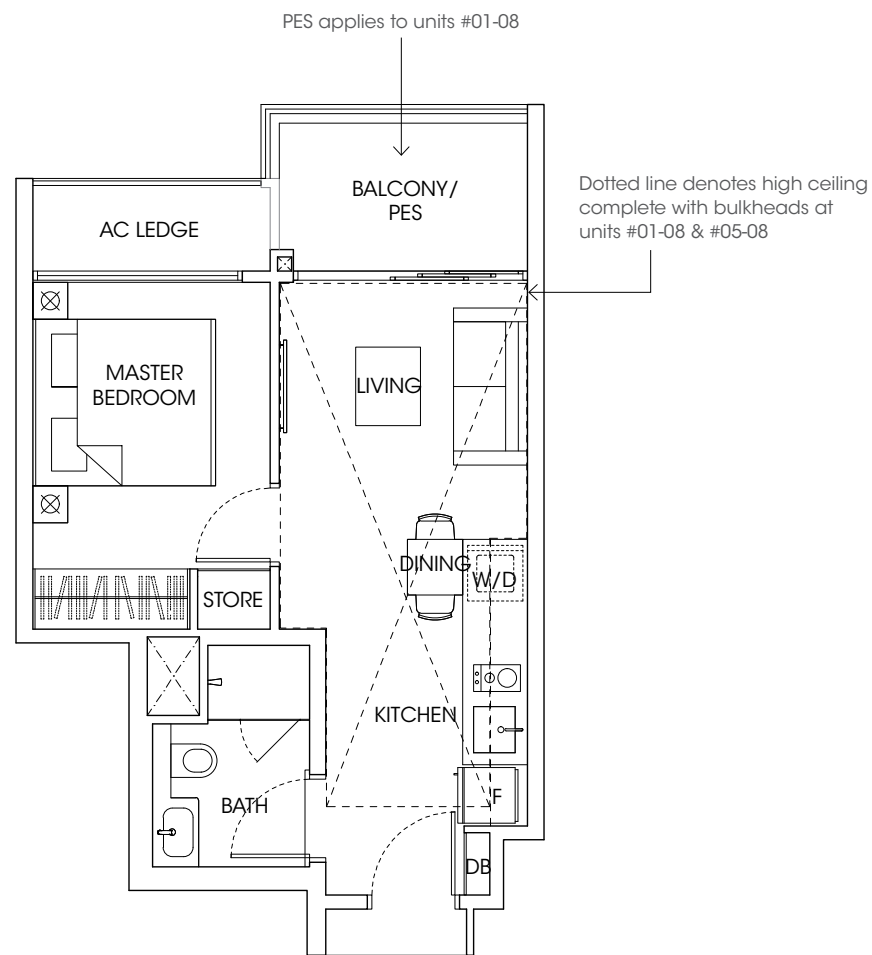
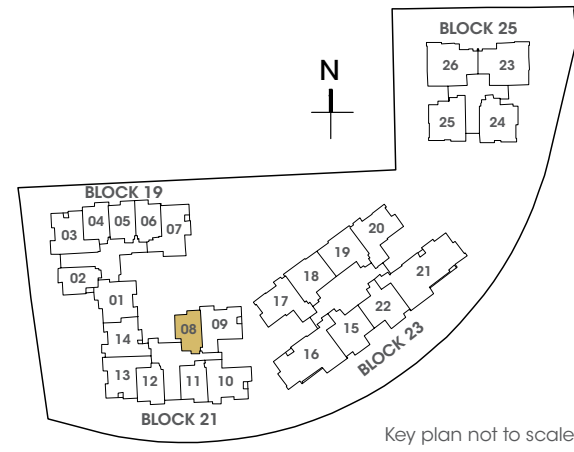

LEGEND:

- Washer/Dryer
- Fridge
- Distribution Board

All plans are subject to changes by the relevant authorities. Measurements are approximate only and subject to final survey. Information accurate at the point of printing. BP no.: A712-04181-2018-BP01

**TYPE A1B**

42.0 m<sup>2</sup> / 452 ft<sup>2</sup>  
(inclusive of 5m<sup>2</sup> Balcony & 3m<sup>2</sup> AC Ledge)

Blk 19, #02-02 to #04-02

**TYPE A1B-G**

56.0 m<sup>2</sup> / 603 ft<sup>2</sup>  
(inclusive of 5m<sup>2</sup> PES, 3m<sup>2</sup> AC Ledge & 14m<sup>2</sup> Void over Living, Dining & Kitchen)

Blk 19, #01-02

**TYPE A1B-PH**

56.0 m<sup>2</sup> / 603 ft<sup>2</sup>  
(inclusive of 5m<sup>2</sup> Balcony, 3m<sup>2</sup> AC Ledge & 14m<sup>2</sup> Void over Living, Dining & Kitchen)

Blk 19, #05-02

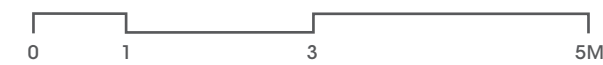
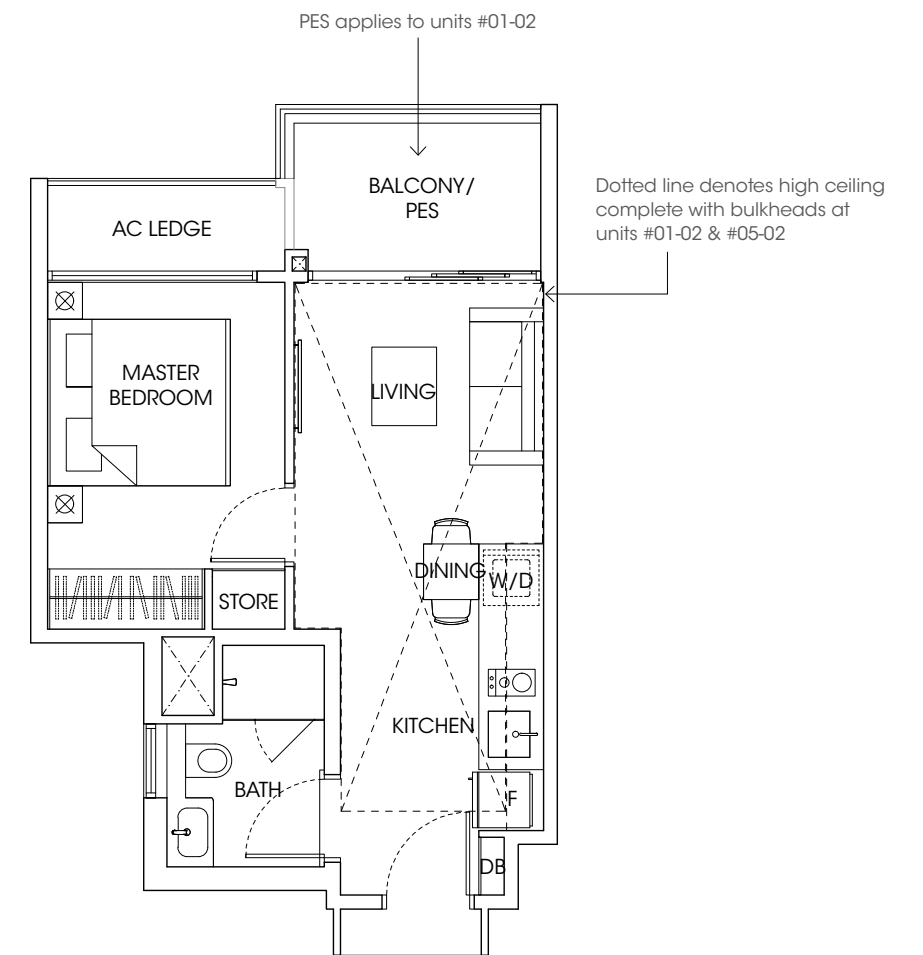
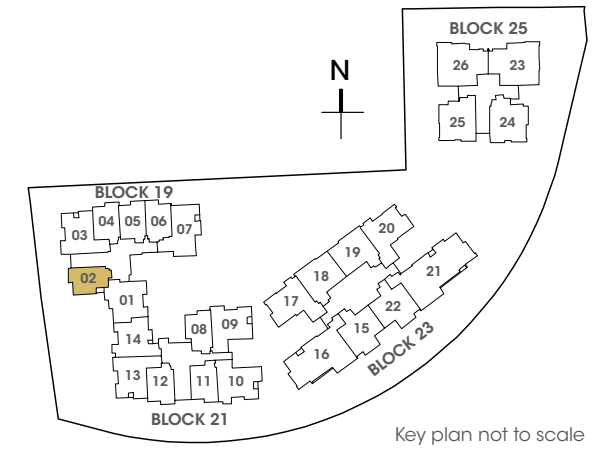

LEGEND:

- Washer/Dryer
- Fridge
- Distribution Board

All plans are subject to changes by the relevant authorities. Measurements are approximate only and subject to final survey. Information accurate at the point of printing. BP no.: A712-04181-2018-BP01

**TYPE B1A**

64.0 m<sup>2</sup> / 689 ft<sup>2</sup>  
(inclusive of 7m<sup>2</sup> Balcony & 5m<sup>2</sup> AC Ledge)

Blk 19, #02-03\* to #04-03\*  
Blk 21, #02-13 to #04-13

**TYPE B1A-G**

82.0 m<sup>2</sup> / 883 ft<sup>2</sup>  
(inclusive of 7m<sup>2</sup> PES, 5m<sup>2</sup> AC Ledge & 18m<sup>2</sup> Void over Living, Dining & Kitchen)

Blk 19, #01-03\*  
Blk 21, #01-13

**TYPE B1A-PH**

82.0 m<sup>2</sup> / 883 ft<sup>2</sup>  
(inclusive of 7m<sup>2</sup> Balcony, 5m<sup>2</sup> AC Ledge & 18m<sup>2</sup> Void over Living, Dining & Kitchen)

Blk 19, #05-03\*  
Blk 21, #05-13

\*Mirror Image

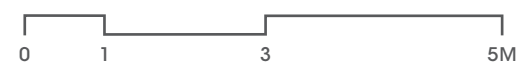
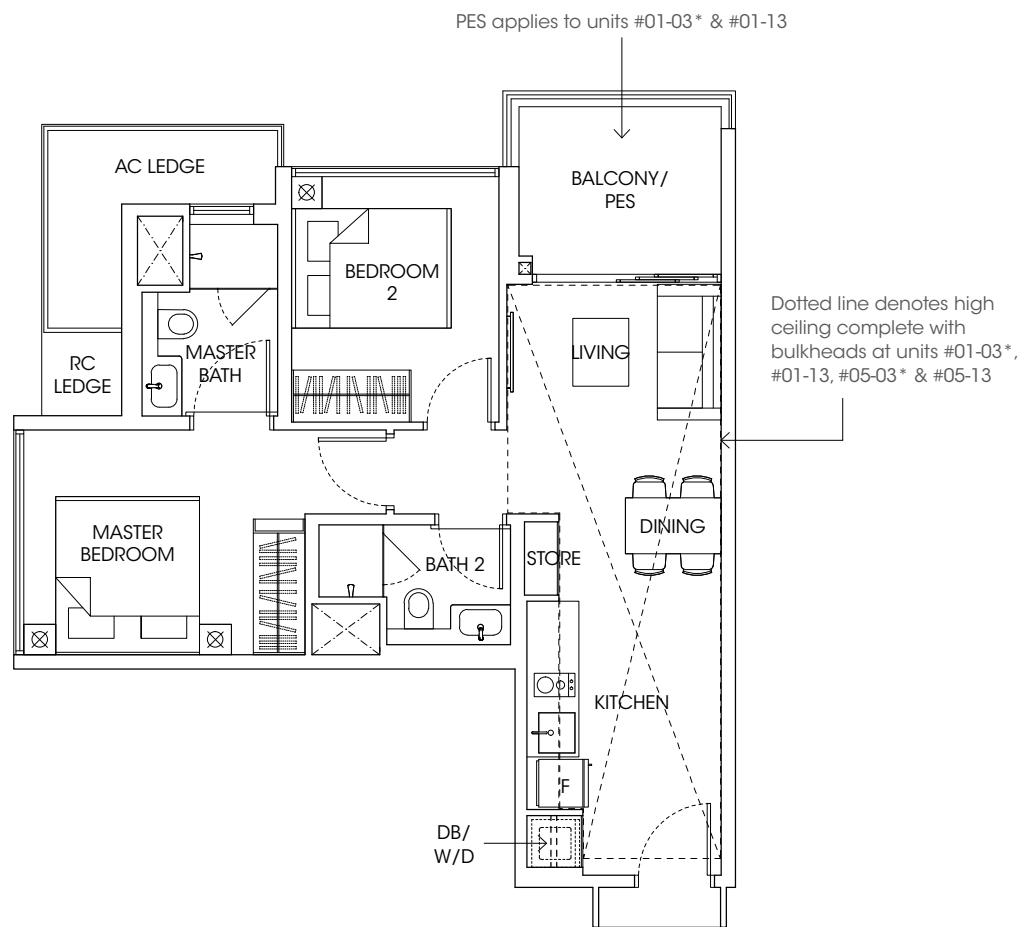
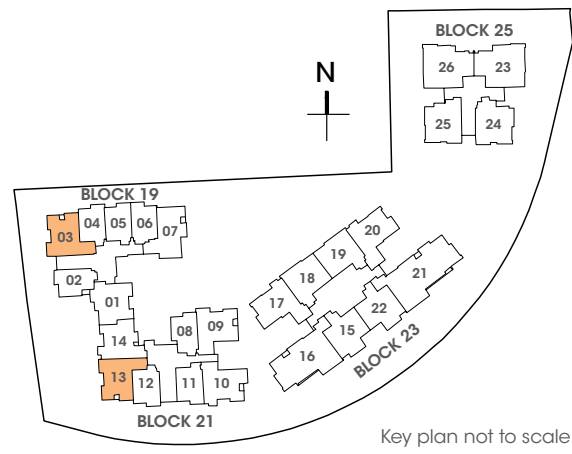

LEGEND:



All plans are subject to changes by the relevant authorities. Measurements are approximate only and subject to final survey. Information accurate at the point of printing. BP no.: A712-04181-2018-BP01

**TYPE B1B**

64.0 m<sup>2</sup> / 689 ft<sup>2</sup>  
(inclusive of 7m<sup>2</sup> Balcony & 5m<sup>2</sup> AC Ledge)

Blk 21, #02-10 to #04-10

**TYPE B1B-G**

80.0 m<sup>2</sup> / 861 ft<sup>2</sup>  
(inclusive of 7m<sup>2</sup> PES, 5m<sup>2</sup> AC Ledge & 16m<sup>2</sup> Void over Living, Dining & Kitchen)

Blk 21, #01-10

**TYPE B1B-PH**

80.0 m<sup>2</sup> / 861 ft<sup>2</sup>  
(inclusive of 7m<sup>2</sup> Balcony, 5m<sup>2</sup> AC Ledge & 16m<sup>2</sup> Void over Living, Dining & Kitchen)

Blk 21, #05-10

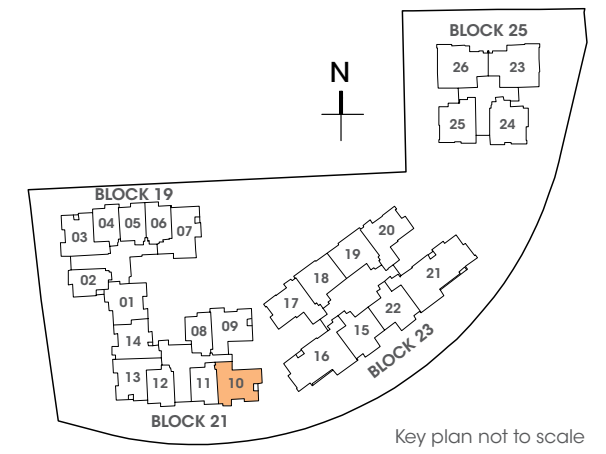

Store layout applies to units #02-10 to #04-10

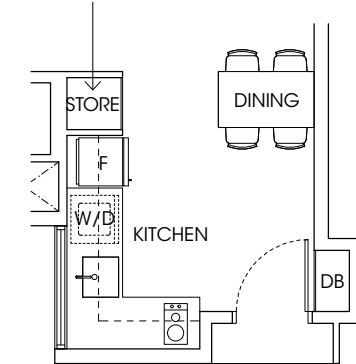

PES applies to units #01-10

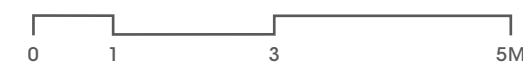
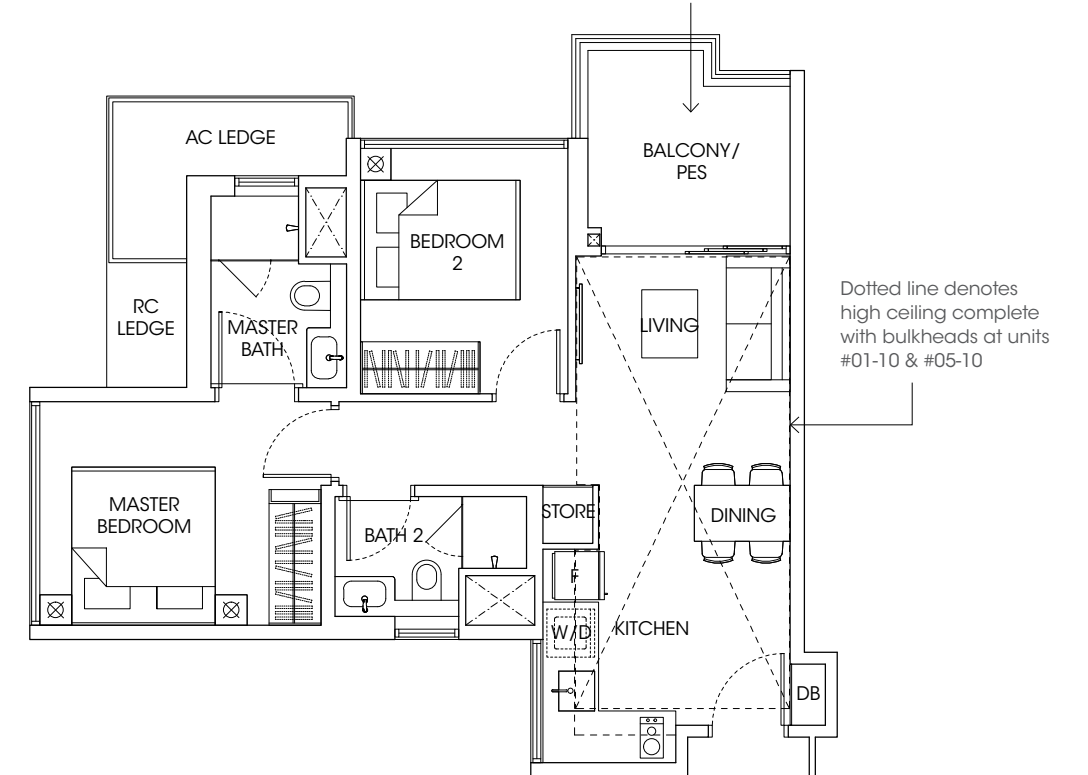

LEGEND:



All plans are subject to changes by the relevant authorities. Measurements are approximate only and subject to final survey. Information accurate at the point of printing. BP no.: A712-04181-2018-BP01

**TYPE B1C**

63.0 m<sup>2</sup> / 678 ft<sup>2</sup>  
(inclusive of 7m<sup>2</sup> Balcony & 5m<sup>2</sup> AC Ledge)

Blk 21, #02-14 to #04-14

**TYPE B1C-G**

79.0 m<sup>2</sup> / 850 ft<sup>2</sup>  
(inclusive of 7m<sup>2</sup> PES, 5m<sup>2</sup> AC Ledge & 16m<sup>2</sup> Void over Living, Dining & Kitchen)

Blk 21, #01-14

**TYPE B1C-PH**

79.0 m<sup>2</sup> / 850 ft<sup>2</sup>  
(inclusive of 7m<sup>2</sup> Balcony, 5m<sup>2</sup> AC Ledge & 16m<sup>2</sup> Void over Living, Dining & Kitchen)

Blk 21, #05-14

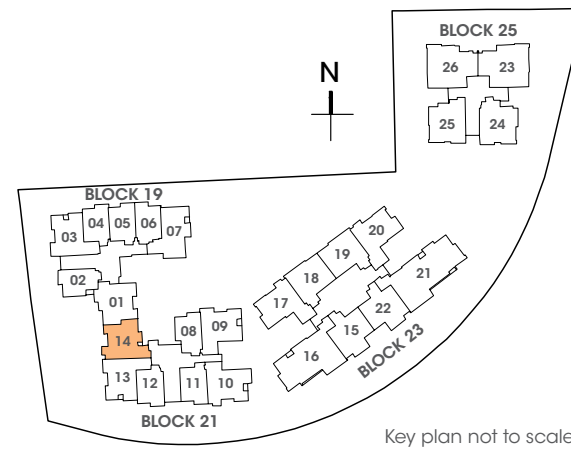

**TYPE B1D**

62.0 m<sup>2</sup> / 667 ft<sup>2</sup>  
(inclusive of 7m<sup>2</sup> Balcony & 4m<sup>2</sup> AC Ledge)

Blk 19, #02-01 to #04-01

**TYPE B1D-G**

76.0 m<sup>2</sup> / 818 ft<sup>2</sup>  
(inclusive of 7m<sup>2</sup> PES, 4m<sup>2</sup> AC Ledge & 14m<sup>2</sup> Void over Living & Dining)

Blk 19, #01-01

**TYPE B1D-PH**

76.0 m<sup>2</sup> / 818 ft<sup>2</sup>  
(inclusive of 7m<sup>2</sup> Balcony, 4m<sup>2</sup> AC Ledge & 14m<sup>2</sup> Void over Living & Dining)

Blk 19, #05-01

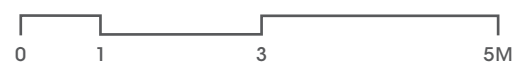
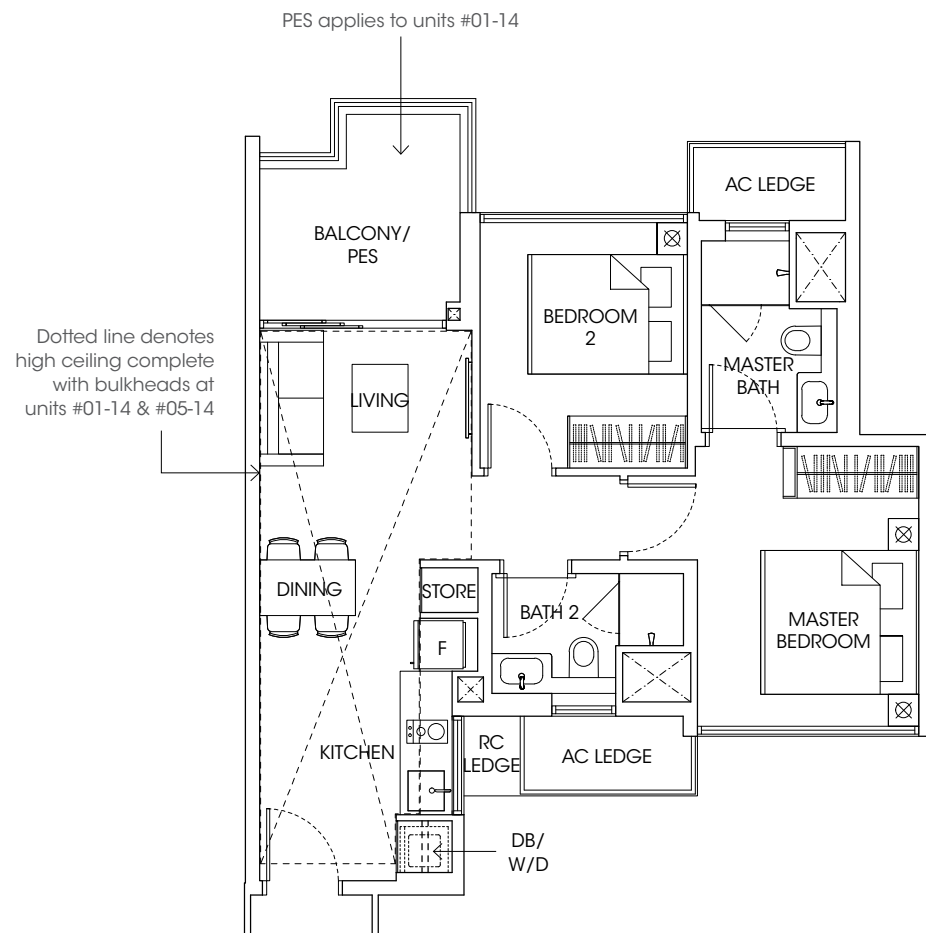
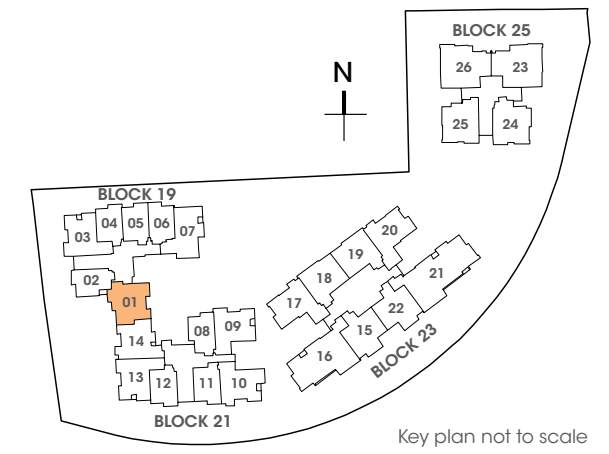

LEGEND:



All plans are subject to changes by the relevant authorities. Measurements are approximate only and subject to final survey. Information accurate at the point of printing. BP no.: A712-04181-2018-BP01

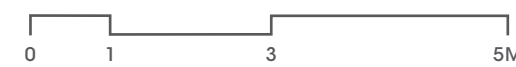
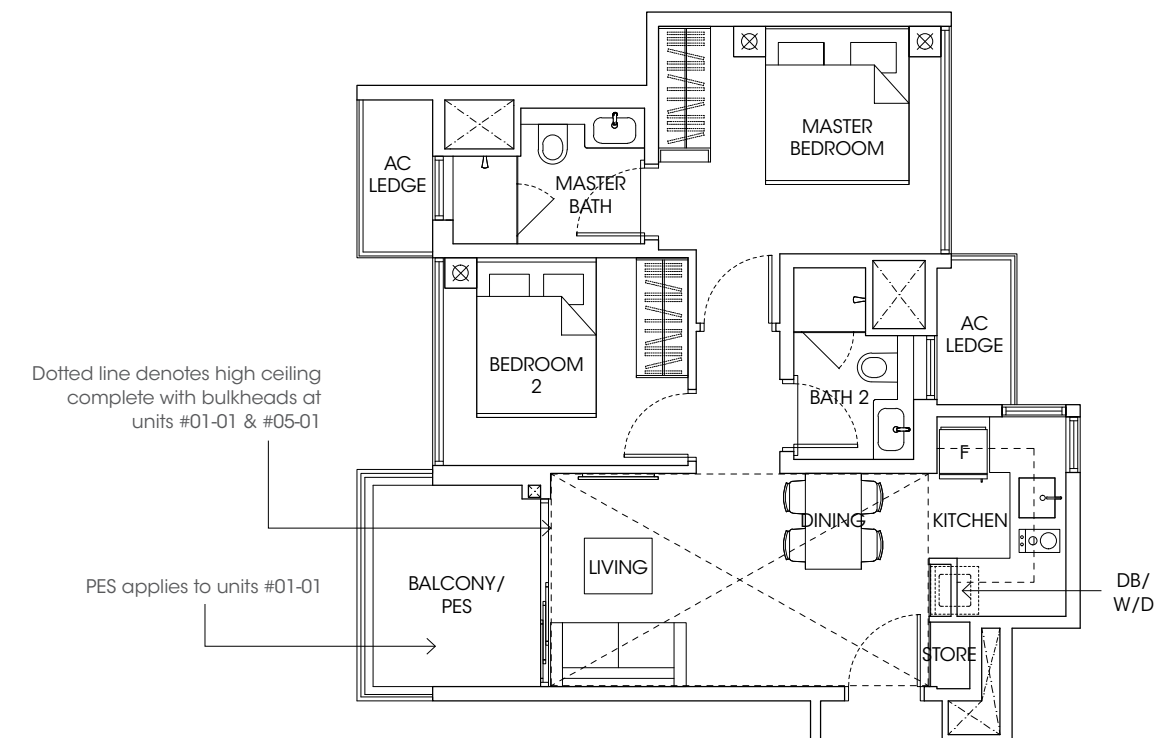

LEGEND:

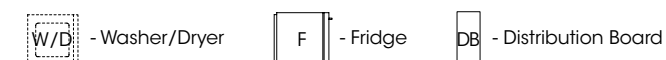

All plans are subject to changes by the relevant authorities. Measurements are approximate only and subject to final survey. Information accurate at the point of printing. BP no.: A712-04181-2018-BP01

**TYPE B1E**

65.0 m<sup>2</sup> / 700 ft<sup>2</sup>  
(inclusive of 8m<sup>2</sup> Balcony & 4m<sup>2</sup> AC Ledge)

Blk 19, #02-07 to #04-07

**TYPE B1E-G**

82.0 m<sup>2</sup> / 883 ft<sup>2</sup>  
(inclusive of 8m<sup>2</sup> PES, 4m<sup>2</sup> AC Ledge & 17m<sup>2</sup> Void over Living, Dining & Kitchen)

Blk 19, #01-07

**TYPE B1E-PH**

82.0 m<sup>2</sup> / 883 ft<sup>2</sup>  
(inclusive of 8m<sup>2</sup> Balcony, 4m<sup>2</sup> AC Ledge & 17m<sup>2</sup> Void over Living, Dining & Kitchen)

Blk 19, #05-07

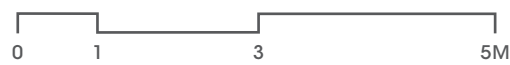
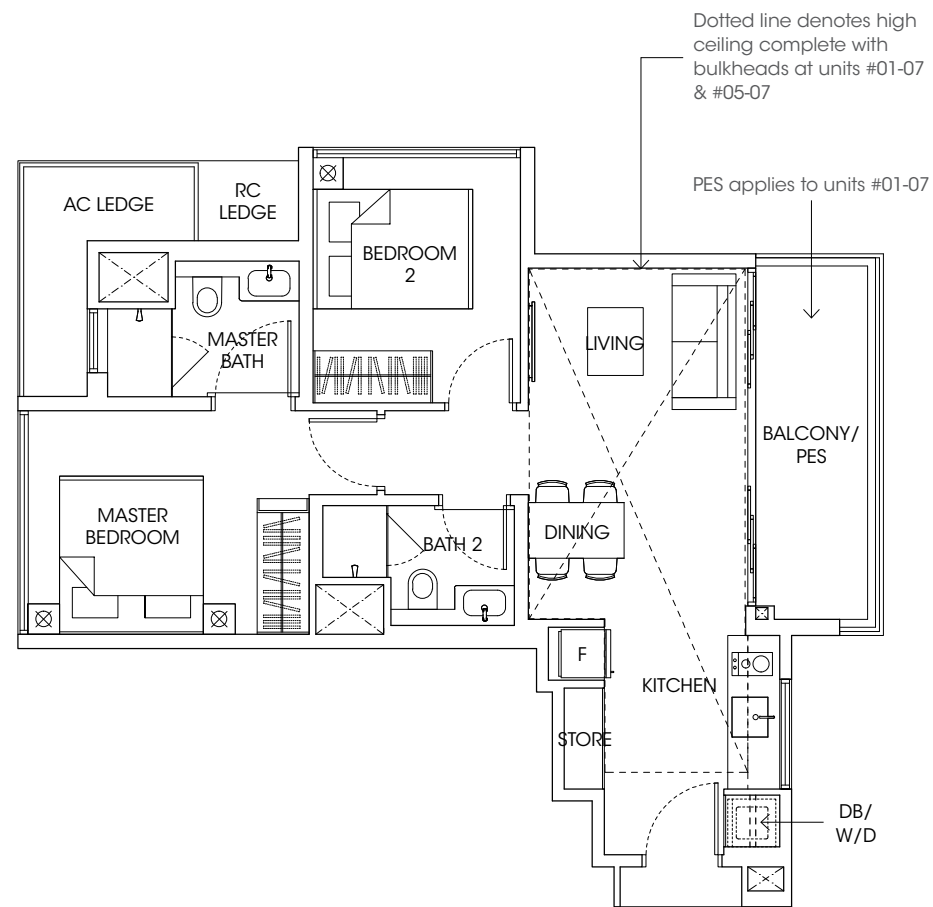
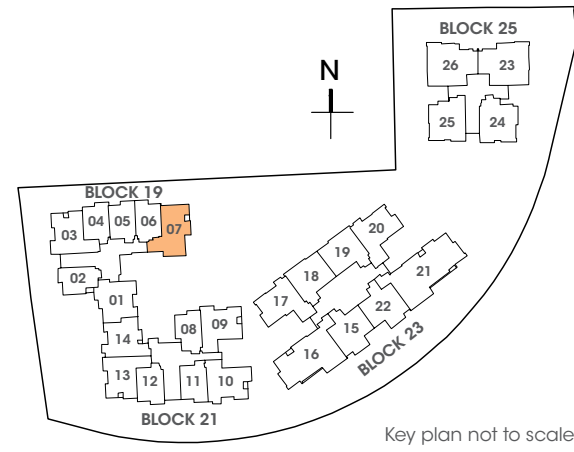

LEGEND:



All plans are subject to changes by the relevant authorities. Measurements are approximate only and subject to final survey. Information accurate at the point of printing. BP no.: A712-04181-2018-BP01

**TYPE B1F**

64.0 m<sup>2</sup> / 689 ft<sup>2</sup>  
(inclusive of 7m<sup>2</sup> Balcony & 4m<sup>2</sup> AC Ledge)

Blk 21, #02-09 to #04-09

**TYPE B1F-G**

77.0 m<sup>2</sup> / 829 ft<sup>2</sup>  
(inclusive of 7m<sup>2</sup> PES, 4m<sup>2</sup> AC Ledge & 13m<sup>2</sup> Void over Living & Dining)

Blk 21, #01-09

**TYPE B1F-PH**

77.0 m<sup>2</sup> / 829 ft<sup>2</sup>  
(inclusive of 7m<sup>2</sup> Balcony, 4m<sup>2</sup> AC Ledge & 13m<sup>2</sup> Void over Living & Dining)

Blk 21, #05-09

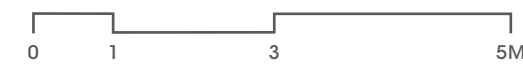
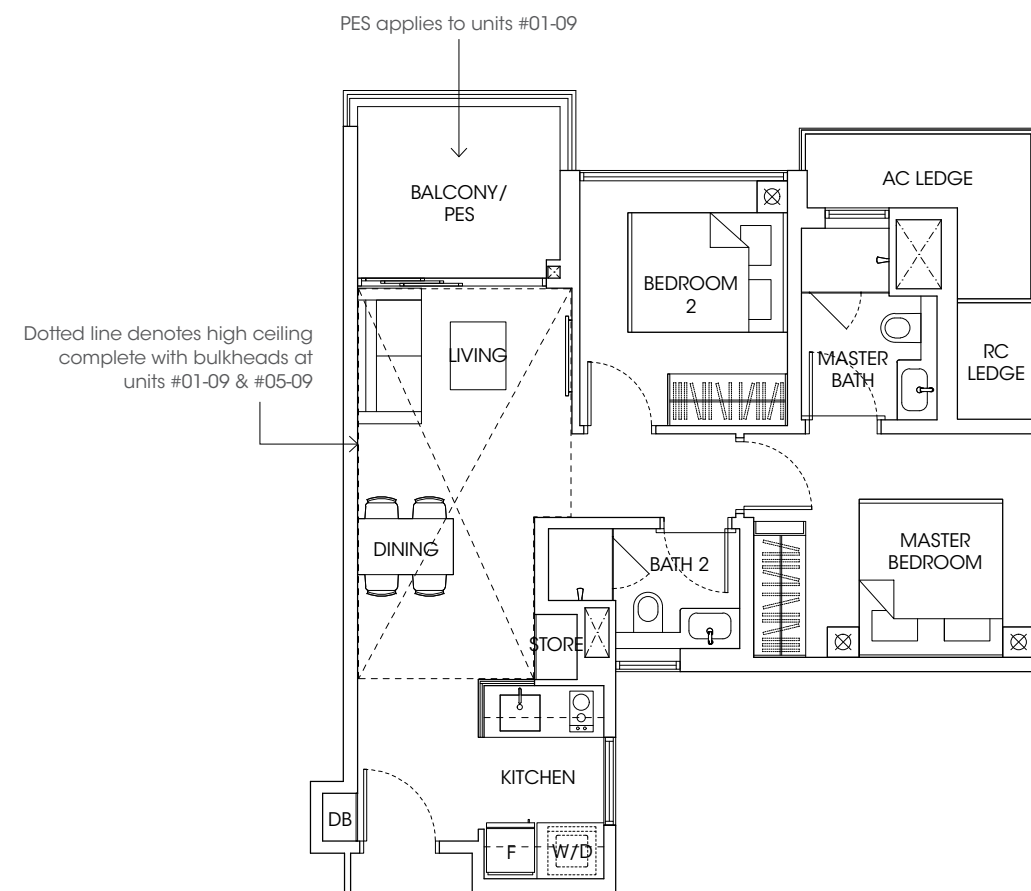
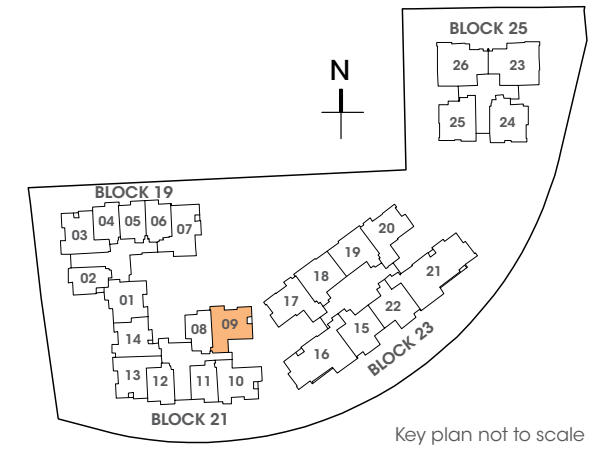

LEGEND:



All plans are subject to changes by the relevant authorities. Measurements are approximate only and subject to final survey. Information accurate at the point of printing. BP no.: A712-04181-2018-BP01

**TYPE B2**

68.0 m<sup>2</sup> / 732 ft<sup>2</sup>  
(inclusive of 6m<sup>2</sup> Balcony & 5m<sup>2</sup> AC Ledge)

Blk 23, #02-17 to #16-17  
#02-20\* to #16-20\*

**TYPE B2-PH**

80.0 m<sup>2</sup> / 861 ft<sup>2</sup>  
(inclusive of 6m<sup>2</sup> Balcony, 5m<sup>2</sup> AC Ledge & 12m<sup>2</sup> Void over Living & Dining)

Blk 23, #17-17  
#17-20\*

\*Mirror Image

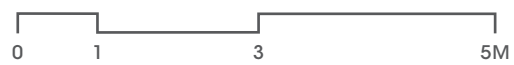
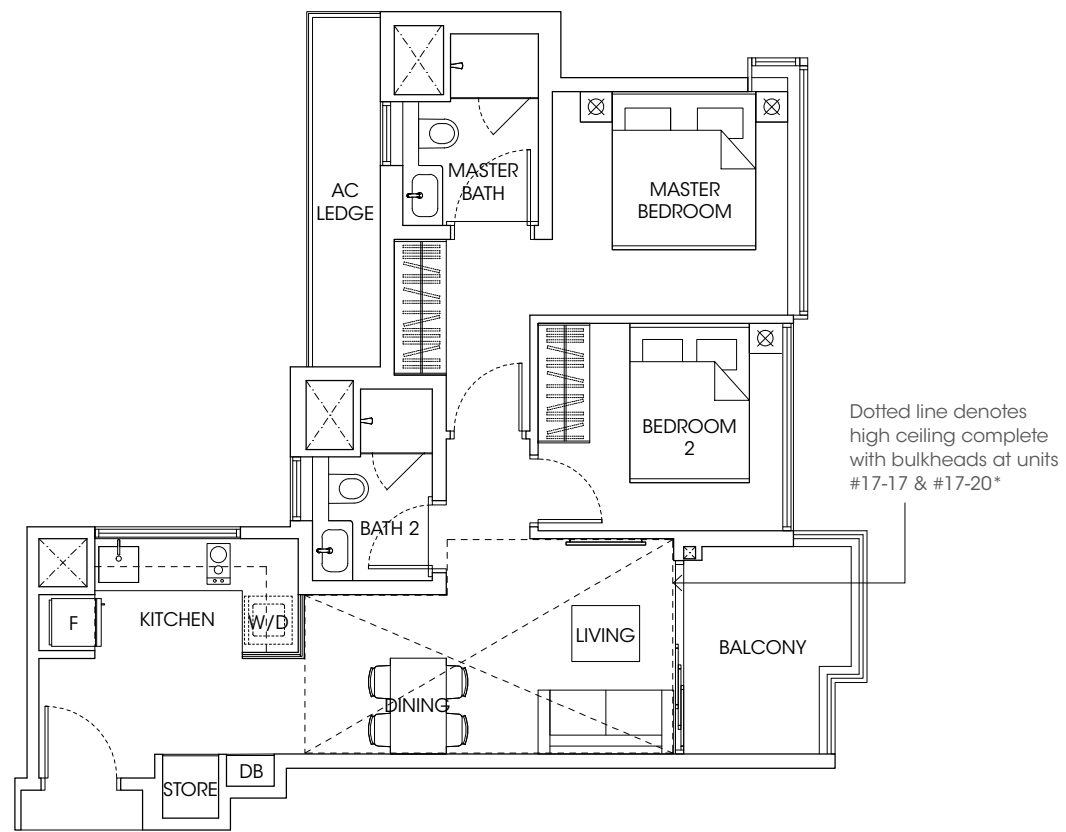
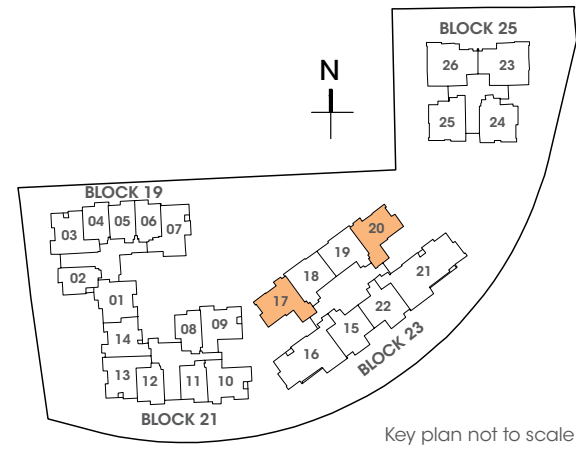

LEGEND:



All plans are subject to changes by the relevant authorities. Measurements are approximate only and subject to final survey. Information accurate at the point of printing. BP no.: A712-04181-2018-BP01

**TYPE B3**

61.0 m<sup>2</sup> / 657 ft<sup>2</sup>  
(inclusive of 7m<sup>2</sup> Balcony & 4m<sup>2</sup> AC Ledge)

Blk 23, #02-15 to #16-15  
#02-22\* to #16-22\*

**TYPE B3-PH**

77.0 m<sup>2</sup> / 829 ft<sup>2</sup>  
(inclusive of 7m<sup>2</sup> Balcony, 4m<sup>2</sup> AC Ledge & 16m<sup>2</sup> Void over Living, Dining & Kitchen)

Blk 23, #17-15  
#17-22\*

\*Mirror Image

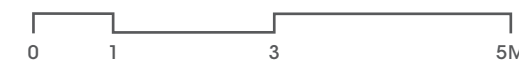
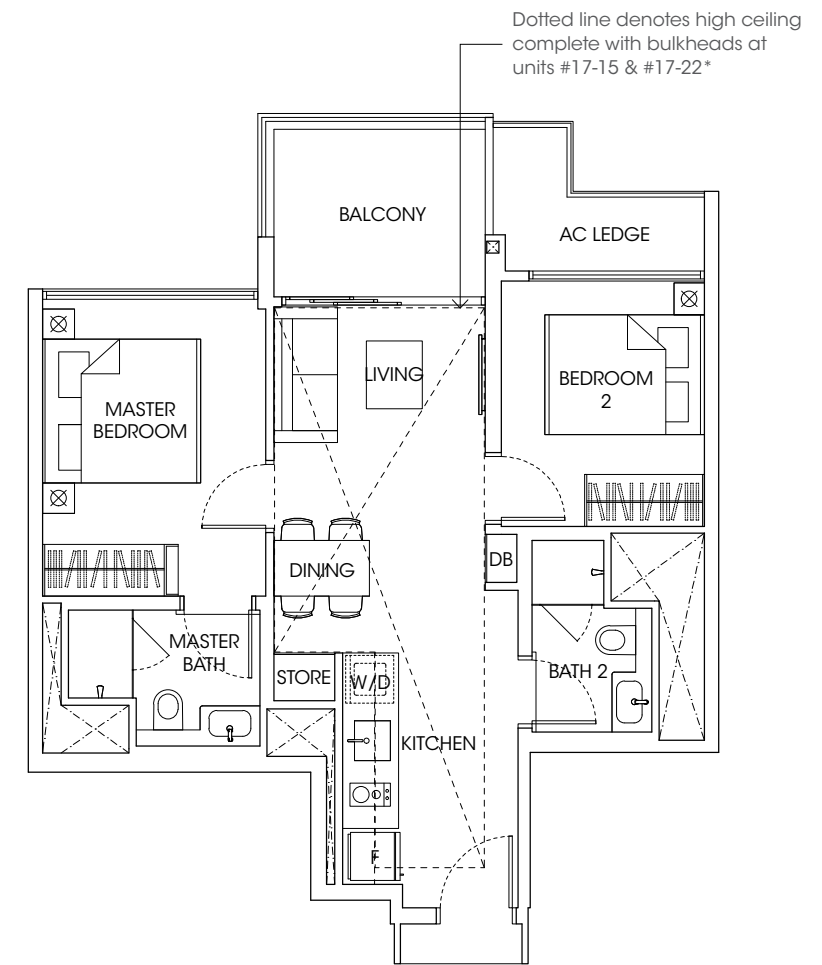
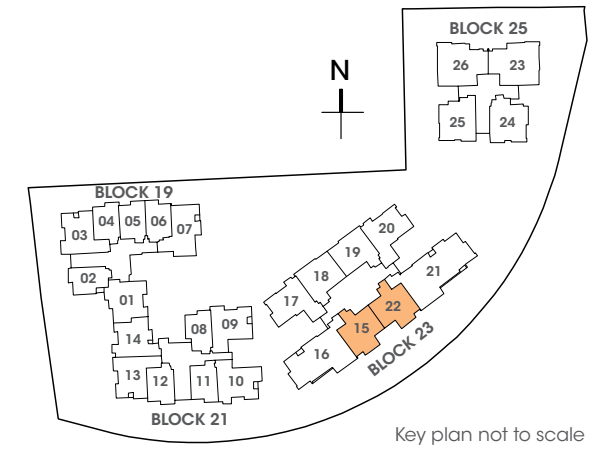

LEGEND:

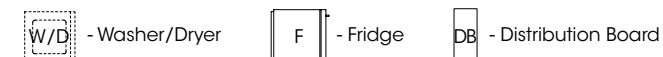

All plans are subject to changes by the relevant authorities. Measurements are approximate only and subject to final survey. Information accurate at the point of printing. BP no.: A712-04181-2018-BP01

**TYPE B4**

62.0 m<sup>2</sup> / 667 ft<sup>2</sup>  
(inclusive of 6m<sup>2</sup> Balcony & 4m<sup>2</sup> AC Ledge)

Blk 23, #02-18\* to #16-18\*  
#02-19 to #16-19

**TYPE B4A**

62.0 m<sup>2</sup> / 667 ft<sup>2</sup>  
(inclusive of 6m<sup>2</sup> Balcony & 4m<sup>2</sup> AC Ledge)

Blk 23, #17-18\*  
#17-19

(Higher ceiling height for Living, Dining, Master Bedroom & Bedroom 2 at 3.285m high)

\*Mirror Image

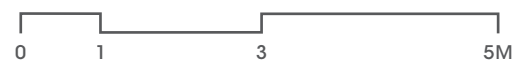
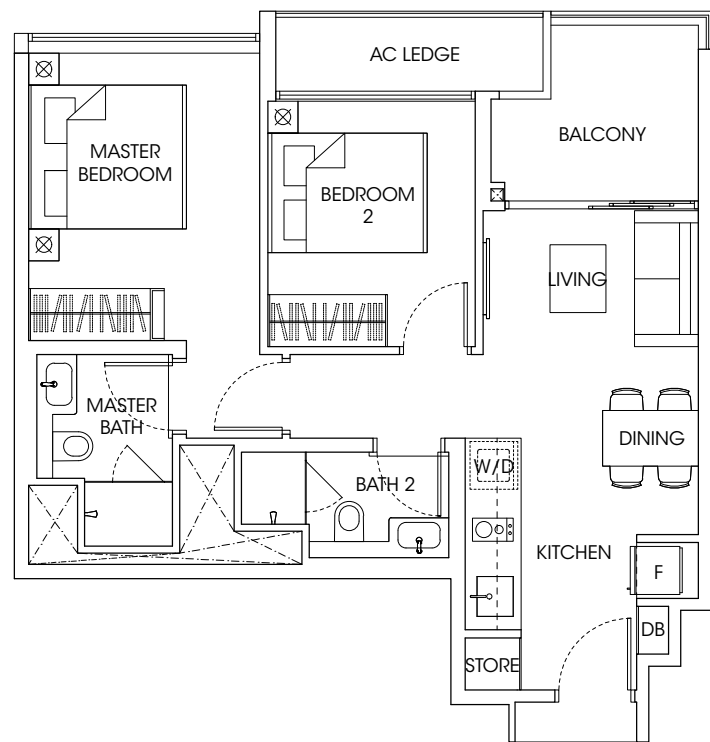
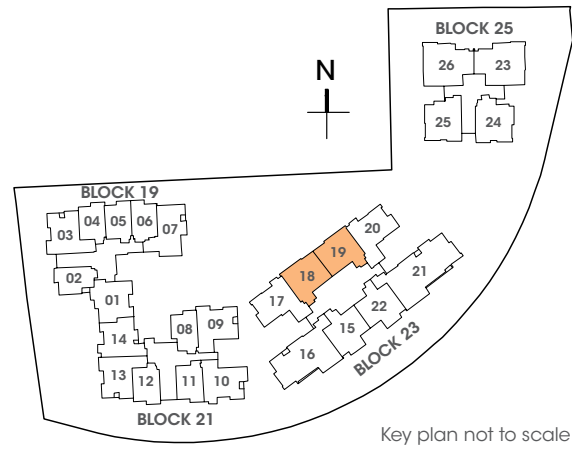

LEGEND:



All plans are subject to changes by the relevant authorities. Measurements are approximate only and subject to final survey. Information accurate at the point of printing. BP no.: A712-04181-2018-BP01

**TYPE B5**

66.0 m<sup>2</sup> / 710 ft<sup>2</sup>  
(inclusive of 7m<sup>2</sup> Balcony & 4m<sup>2</sup> AC Ledge)

Blk 25, #02-24 to #17-24

**TYPE B5-PH**

80.0 m<sup>2</sup> / 861 ft<sup>2</sup>  
(inclusive of 7m<sup>2</sup> Balcony, 4m<sup>2</sup> AC Ledge & 14m<sup>2</sup> Void over Living, Dining & Kitchen)

Blk 25, #18-24

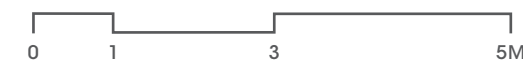
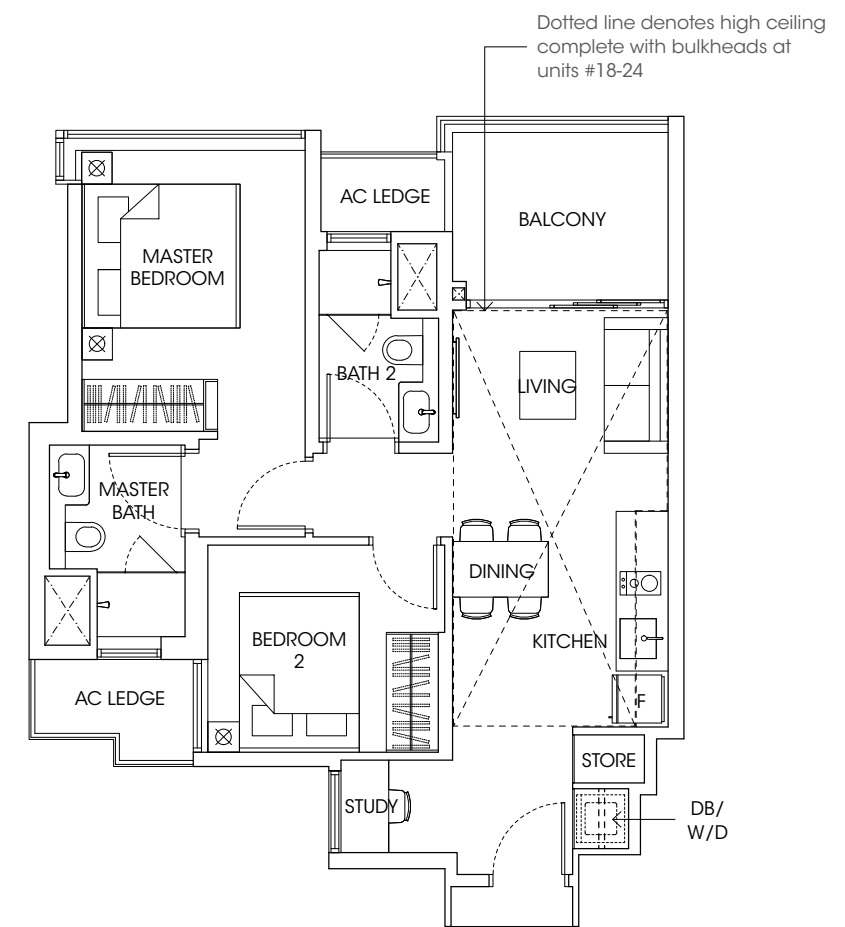
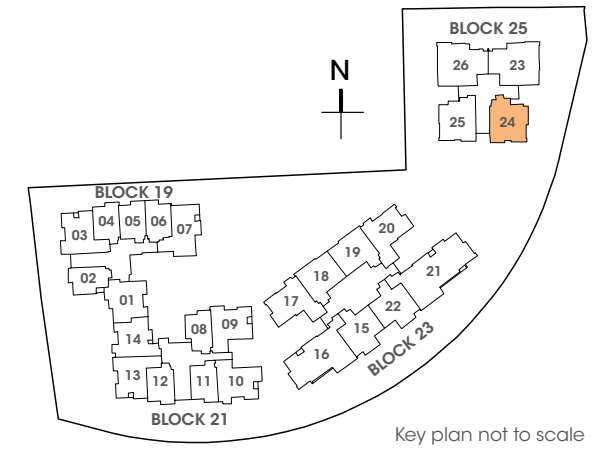

LEGEND:



All plans are subject to changes by the relevant authorities. Measurements are approximate only and subject to final survey. Information accurate at the point of printing. BP no.: A712-04181-2018-BP01



**TYPE B6**

64.0 m<sup>2</sup> / 689 ft<sup>2</sup>  
(inclusive of 7m<sup>2</sup> Balcony & 4m<sup>2</sup> AC Ledge)

Blk 25, #02-25 to #17-25

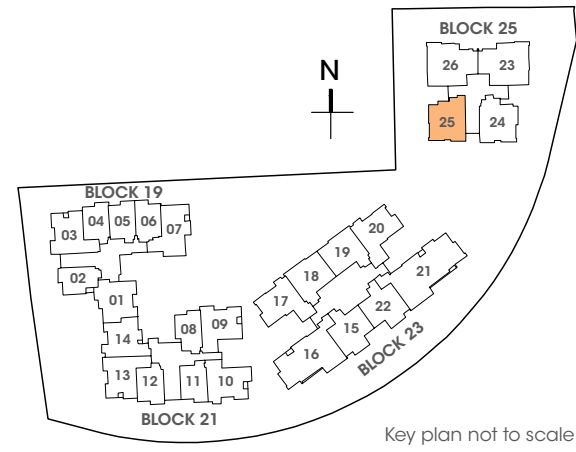

Key plan not to scale

**TYPE C1**

82.0 m<sup>2</sup> / 883 ft<sup>2</sup>  
(inclusive of 10m<sup>2</sup> Balcony & 4m<sup>2</sup> AC Ledge)

Blk 25, #02-23 to #17-23  
#02-26\* to #17-26\*

**TYPE C1-PH**

95.0 m<sup>2</sup> / 1023 ft<sup>2</sup>  
(inclusive of 10m<sup>2</sup> Balcony, 4m<sup>2</sup> AC Ledge & 13m<sup>2</sup> Void over Living & Dining)

Blk 25, #18-23  
#18-26\*

\*Mirror Image

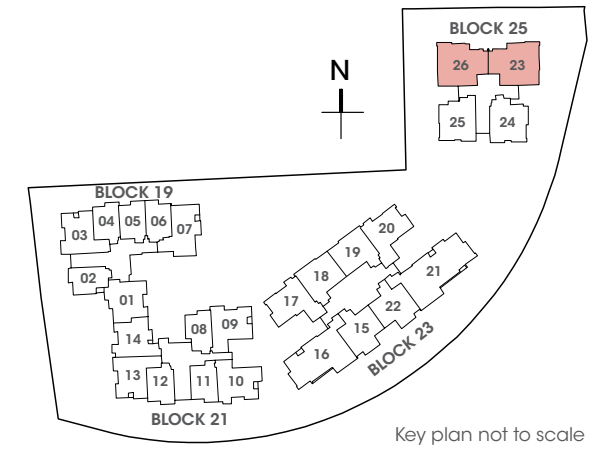

Key plan not to scale

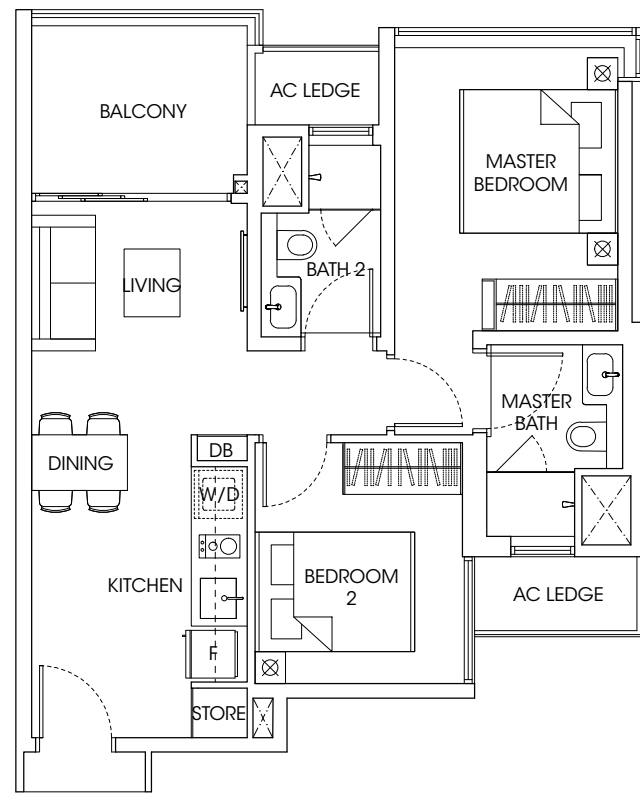

LEGEND:

- Washer/Dryer
- Fridge
- Distribution Board

All plans are subject to changes by the relevant authorities. Measurements are approximate only and subject to final survey. Information accurate at the point of printing. BP no.: A712-04181-2018-BP01

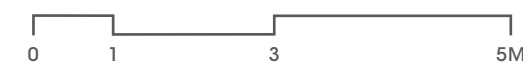
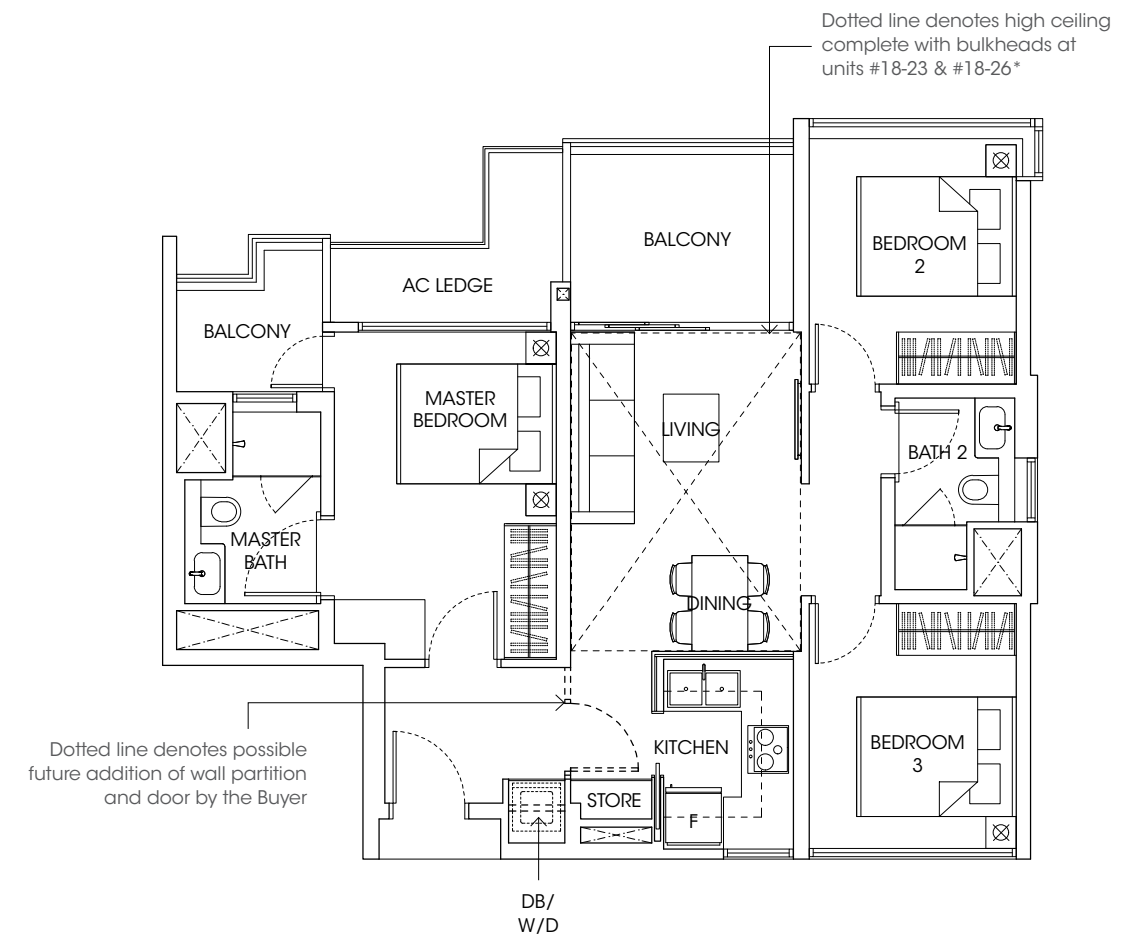

LEGEND:

- Washer/Dryer
- Fridge
- Distribution Board

All plans are subject to changes by the relevant authorities. Measurements are approximate only and subject to final survey. Information accurate at the point of printing. BP no.: A712-04181-2018-BP01



**TYPE C2**

107.0 m<sup>2</sup> / 1152 ft<sup>2</sup>  
(inclusive of 12m<sup>2</sup> Balcony & 7m<sup>2</sup> AC Ledge)

Blk 23, #02-16 to #16-16

**TYPE C2-PH**

127.0 m<sup>2</sup> / 1367 ft<sup>2</sup>  
(inclusive of 12m<sup>2</sup> Balcony, 7m<sup>2</sup> AC Ledge & 20m<sup>2</sup> Void over Dining & Living)

Blk 23, #17-16

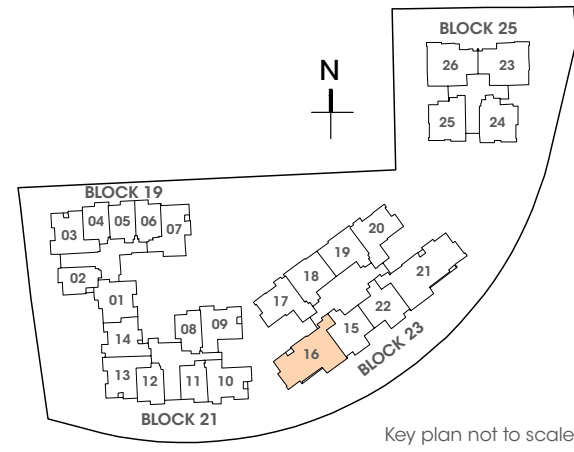

**TYPE D1**

127.0 m<sup>2</sup> / 1367 ft<sup>2</sup>  
(inclusive of 14m<sup>2</sup> Balcony & 7m<sup>2</sup> AC Ledge)

Blk 23, #02-21 to #16-21

**TYPE D1-PH**

149.0 m<sup>2</sup> / 1604 ft<sup>2</sup>  
(inclusive of 14m<sup>2</sup> Balcony, 7m<sup>2</sup> AC Ledge & 22m<sup>2</sup> Void over Living & Dining)

Blk 23, #17-21

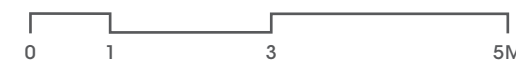
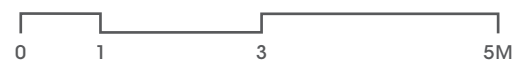
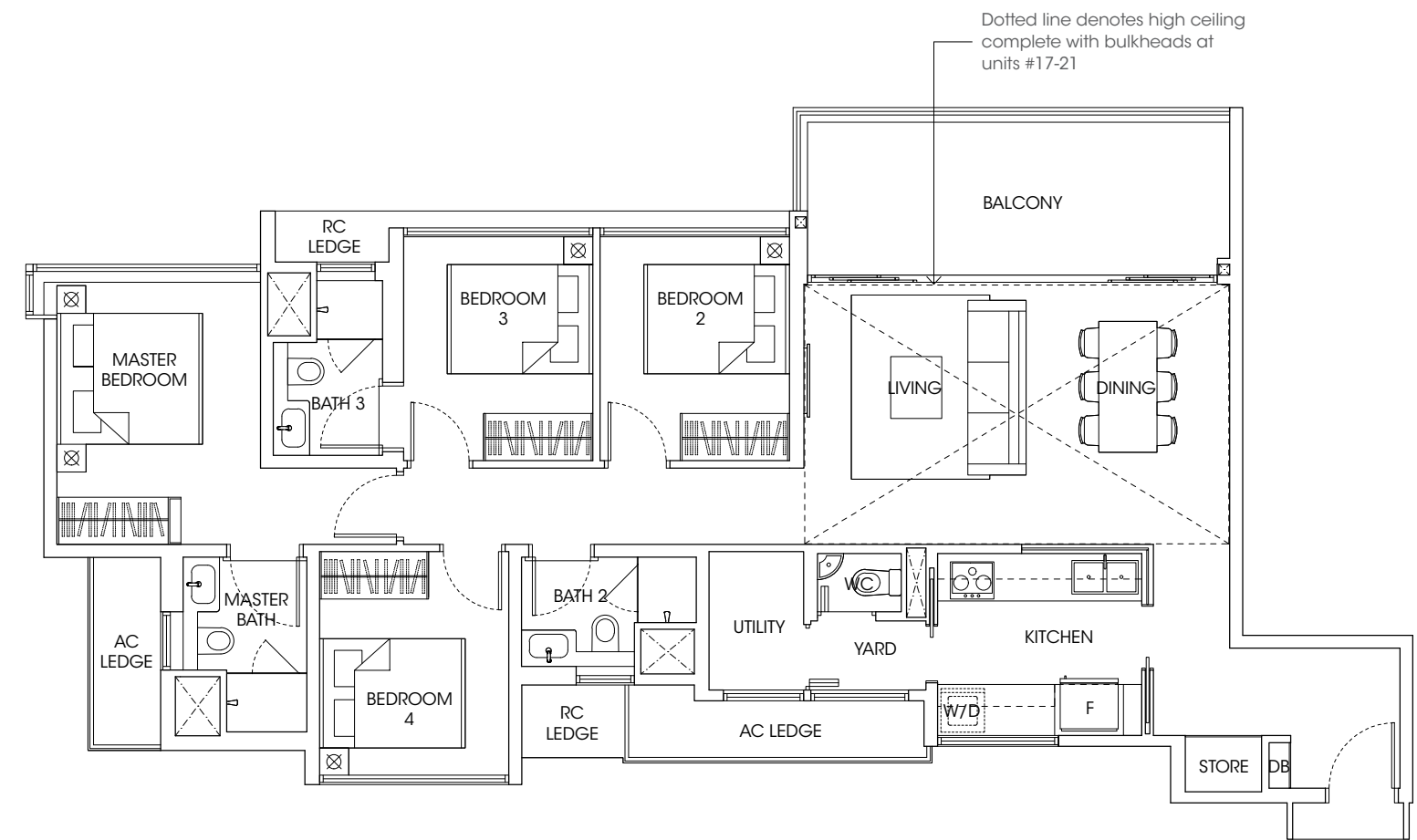
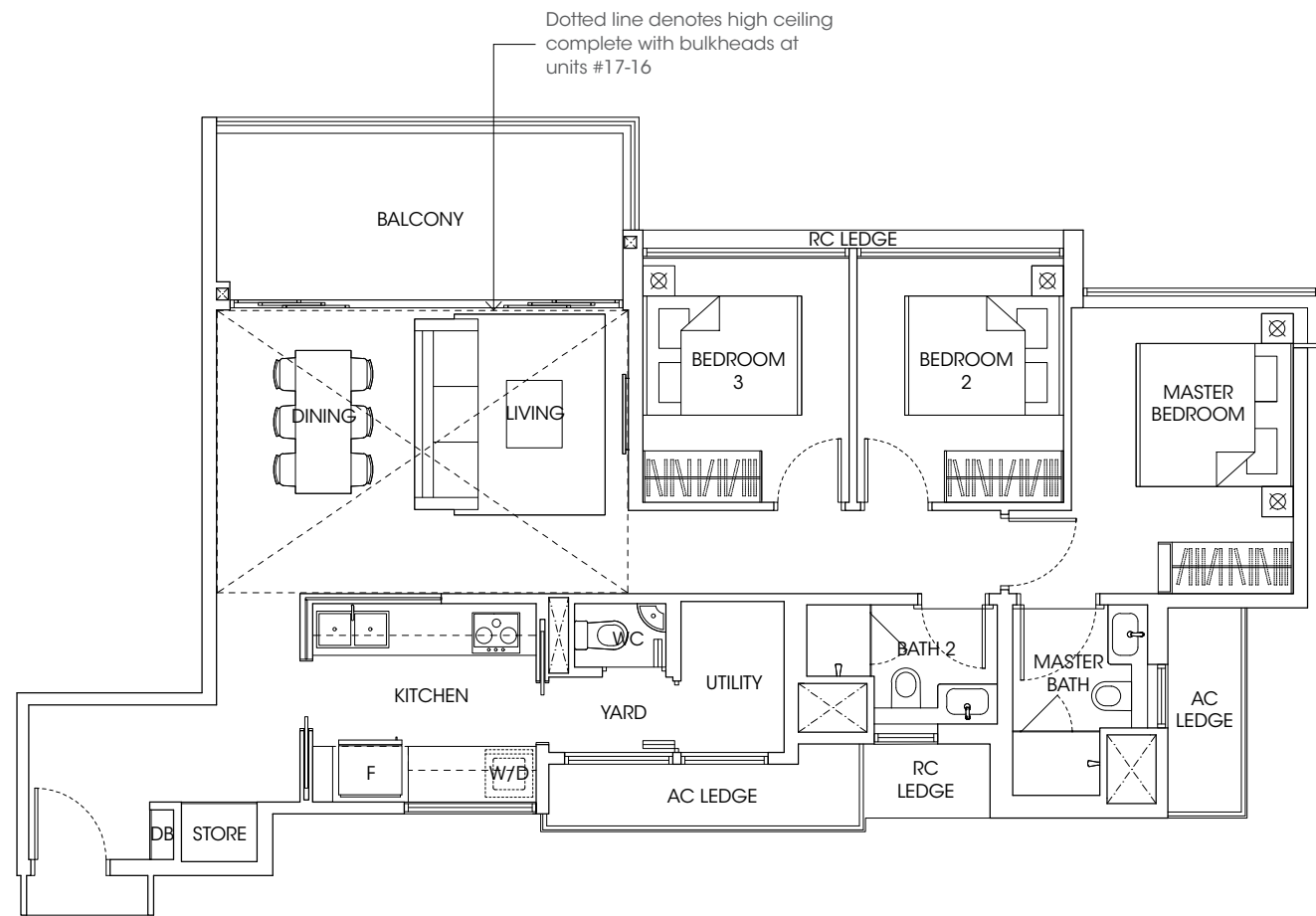
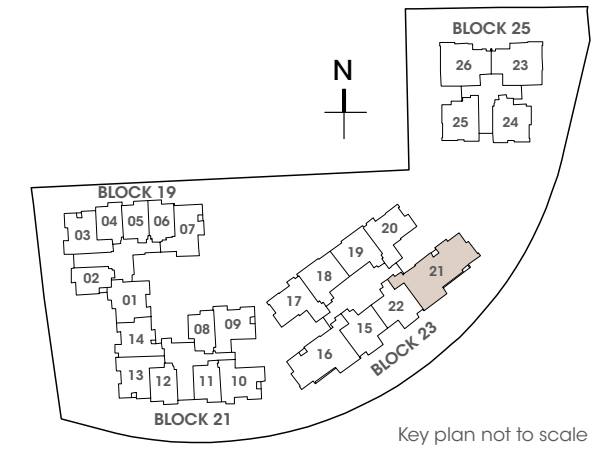

LEGEND:

- Washer/Dryer
- Fridge
- Distribution Board

All plans are subject to changes by the relevant authorities. Measurements are approximate only and subject to final survey. Information accurate at the point of printing. BP no.: A712-04181-2018-BP01

LEGEND:

- Washer/Dryer
- Fridge
- Distribution Board

All plans are subject to changes by the relevant authorities. Measurements are approximate only and subject to final survey. Information accurate at the point of printing. BP no.: A712-04181-2018-BP01